

# REALM 44

ADVENTURE BOATING



REALM 44.

[WWW.RANDBOATS.COM](http://WWW.RANDBOATS.COM)

FROM 439.000 €

RAND

CREATING HARMONY BETWEEN THE OCEANS AND HUMANKIND

# MAKE IT YOUR REALM



Step aboard Realm 44, where the next adventure is at your fingertips. Whether it's a serene overnight stay in a secluded bay or a lively sunset soirée, this fresh take on the popular day yacht genre offers the space and amenities to bring your dreams to life.

At the heart of Realm 44 is the philosophy that experiences are the true currency of life. Its soft solid and functional Danish design empowers you to embrace spontaneity and explore without limits. From distant

shores to lively oceanside towns, this vessel is your passport to new adventures.

Amidst the thrill of discovery, comfort is never compromised. Both indoor and outdoor spaces ensure full living comfort, whether for day trips or when you want to stay for a night

Make the sea your realm, one adventure at a time. Explore Realm 44 now.



## SPACIOUS INDOOR AREA

Below deck, the Realm 44 features a spacious indoor living area designed with both comfort and functionality in mind. The spacious lounge area, enhanced by panoramic windows and a skylight, creates an open and airy atmosphere, making you feel connected to the outdoors while remaining protected from the elements in comfort. Sleeping quarters accommodate four, including a forward queen size bed and a mid-ship twin cabin.

The kitchen is fully equipped with Siemens appliances, ensuring you can prepare meals with ease. The cabin's full-standing height interior provides a sense of freedom and room for movement, reflecting an ergonomic design that prioritizes your comfort. Meanwhile, the bathroom features a separate shower cabin and a toilet, ensuring you have all the conveniences of home while adventuring.



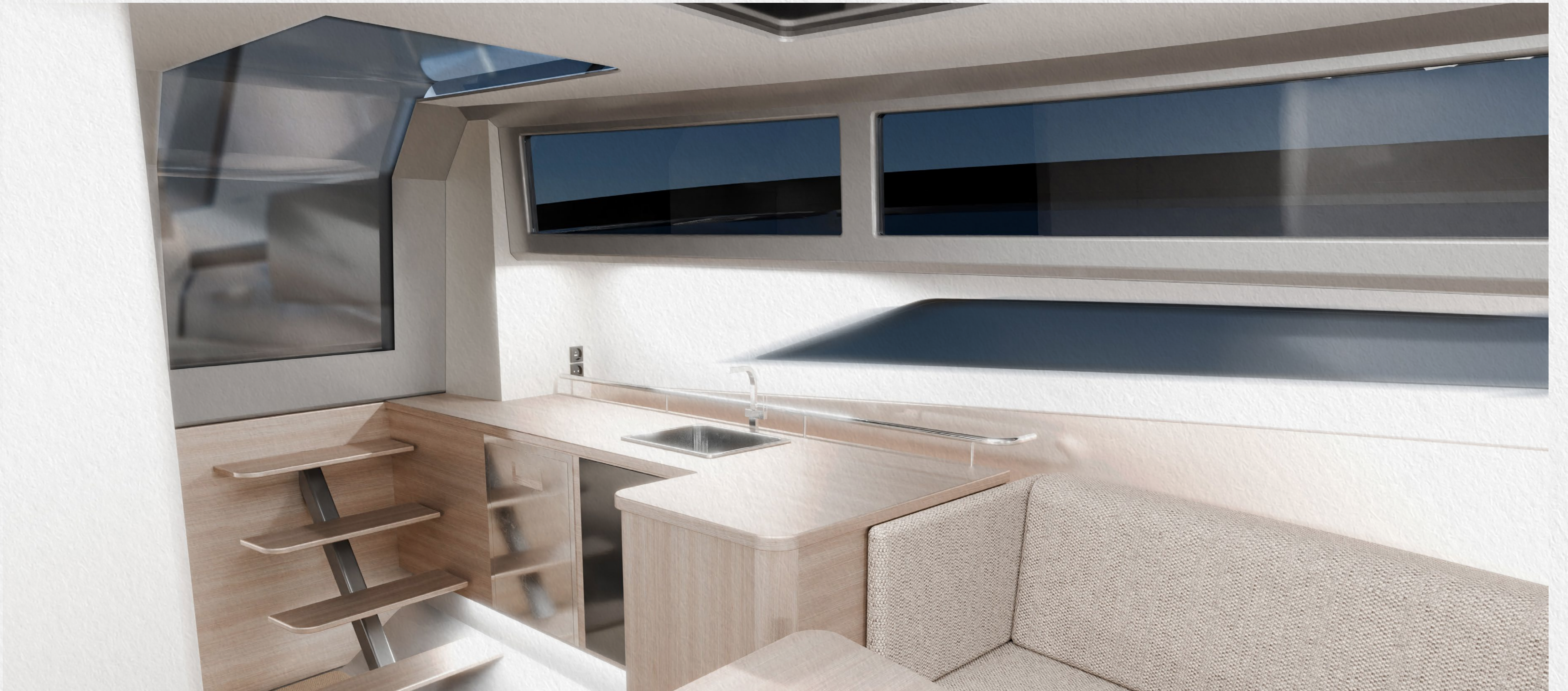

MID CABIN & KITCHEN



## OUTDOOR LIVING SPACE

Above deck, the expansive outdoor living space is thoughtfully designed for both relaxation and socializing. Protected from the elements by a solid stainless steel and large composite roof, this area ensures you can enjoy the outdoors in any weather. The central U-shaped sofa accommodates up to eleven people, making it the perfect space for memorable gatherings in beautiful surroundings.

Behind the helm station, you'll find a fully equipped wet bar, perfect for preparing local delicacies or signature drinks. The helm station itself features three captain seats, allowing you and your companions to navigate in comfort. A side boarding door near the captain's seat provides easy access to the dock, making it convenient to grab supplies or step ashore. On the opposite side you will find a flip-down bench that serves as a seating space for up to three people, thoughtfully placed close to the central social zone.



REALM 44

# READY FOR OFF-GRID ADVENTURES

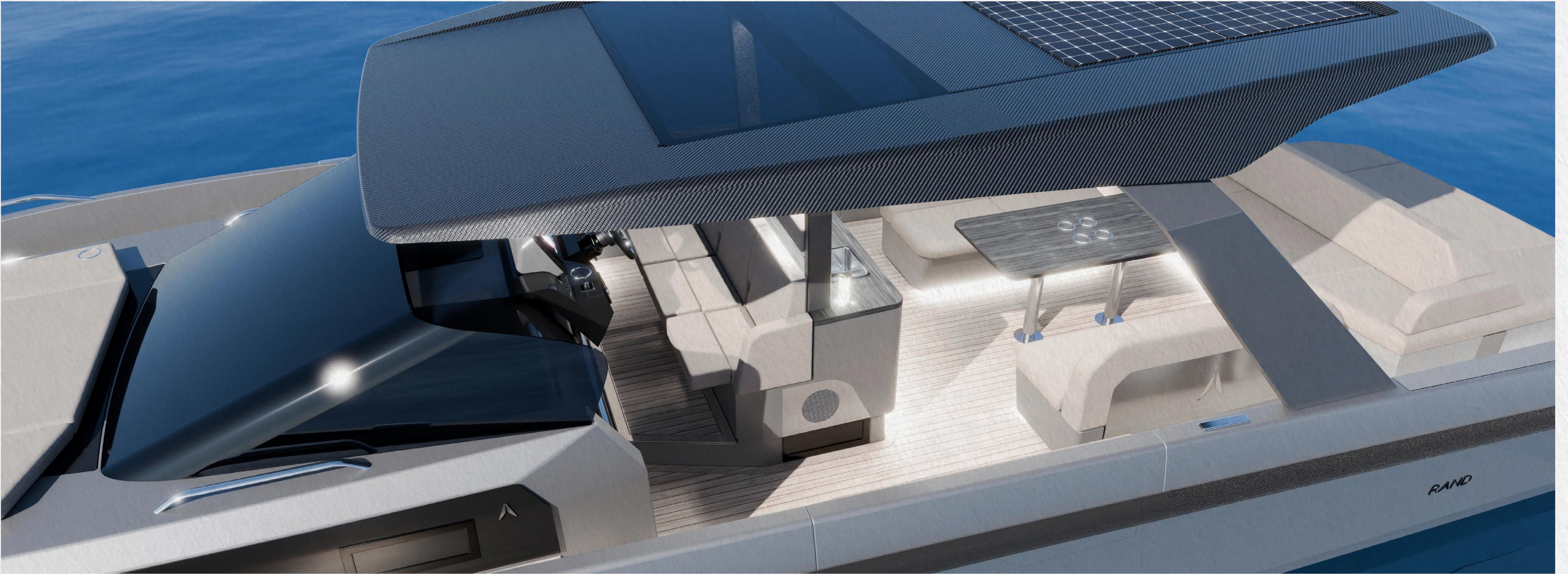

Placed on top of the protective T-top, you will find powerful solar panels that serve as a dynamic source of energy, powering the Realm 44's various systems and powering your off-grid adventures from the battery bank with no genset needed.

With the Realm 44's off-shore hull featuring a 28-degree forward deadrise, you can enjoy a very soft and smooth ride in all weather conditions, further elevating your on-water adventures. Meanwhile, the high and broad freeboard creates extra protection and a sensation of safety while sailing, even in rougher weather.

## AFT LOUNGE AND STORAGE

At the aft, a chaise-lounge-sized sunbed with a movable backrest can transform into a full 2-meter-deep lounging area, ideal for soaking up the sun and enjoying uninterrupted views. This sunbed comfortably fits up to five people, offering ample space for relaxation with a further three person sunbed in the front.

Beneath it lie two separate large storage areas on top of each other, accessible via a convenient stairway. The top storage area can accommodate an inflated tender boat, while the storage area beneath it is suitable for scuba diving gear, paddle boards, or other odd-sized equipment. Adjacent to this, the 130 x 350



cm aft swim platform, positioned close to the water surface, enhances your engagement with the ocean, making it easy to take a dip or launch water activities.

## REALM 44

PRICE FROM 439.000 €

MODEL	REALM 44
HULL LENGTH	1350CM
HULL WIDTH	399CM
WEIGHT EXCL. ENGINE	6500KG

## ELECTRIC ENGINE & RANGE

2X 300KW INBOARD INCL. 440 KWH BATTERY	CRUISING RANGE (8 KT): +300 KM
	TOP SPEED: 40 KNOTS

## PETROL ENGINE & TOP SPEED

2X MERCURY F400 OUTBOARDS	TOP SPEED: 44 KNOTS
2X MERCURY F600 OUTBOARD	TOP SPEED: 52 KNOTS
2X MERCUISER 6.2L-350HP STERNDRIVE	TOP SPEED: 40 KNOTS
2X YANMAR DIESEL 370 HP STERNDRIVE	TOP SPEED: 42 KNOTS

\*All performance figures are calculated and are intended as an indication. These figures cannot be guaranteed, as top speed and duration are affected by the cleanliness of the hull, conditions of the propellers, weight carried, and the condition of the sea. Equipment selections and production processes may lead to variations in the boat's stated weight.

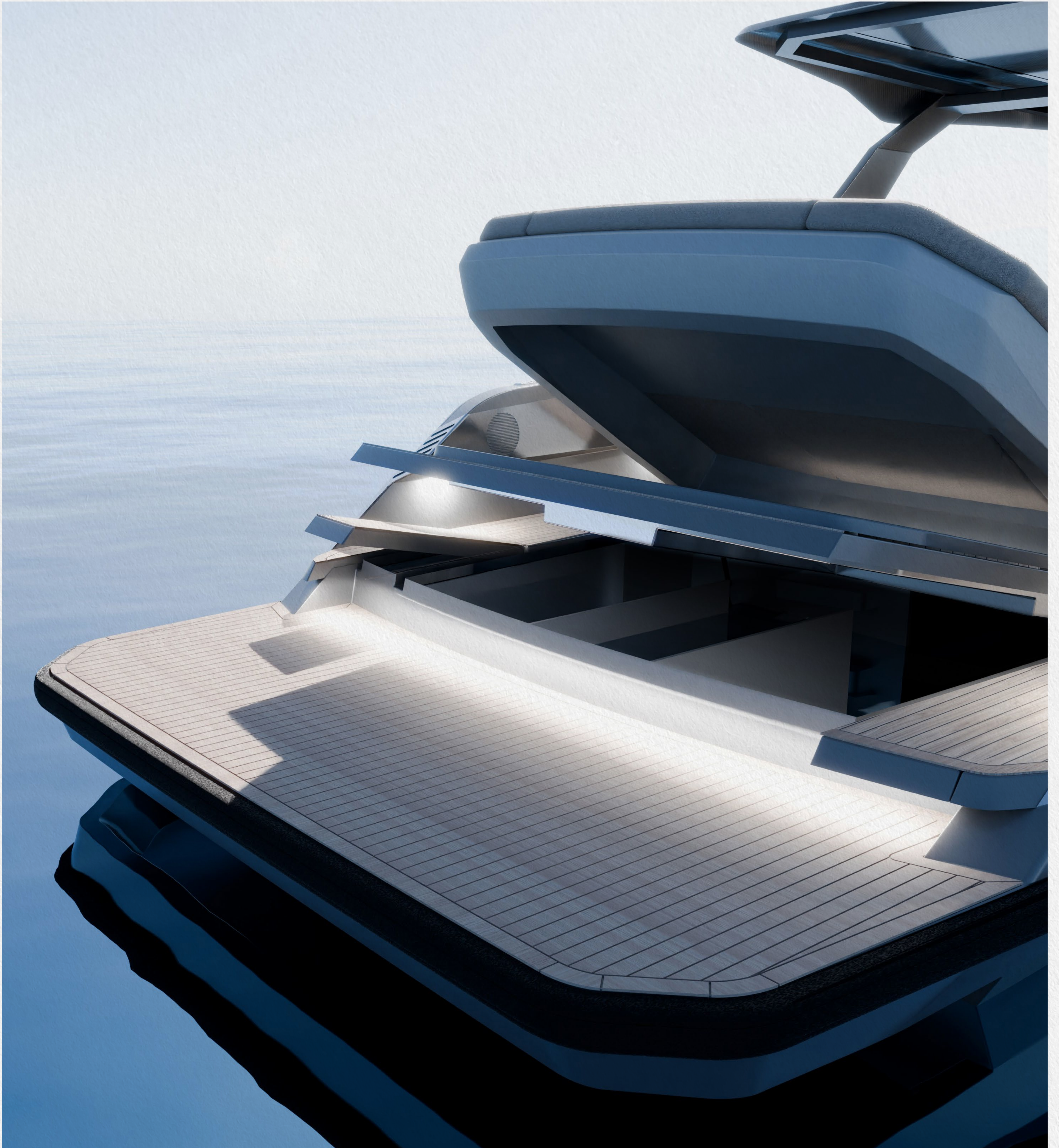

RAND

[WWW.RANDBOATS.COM](http://WWW.RANDBOATS.COM) | [@RANDBOATS](https://www.instagram.com/RANDBOATS) | [FACEBOOK: RANDBOATS](https://www.facebook.com/RANDBOATS)